

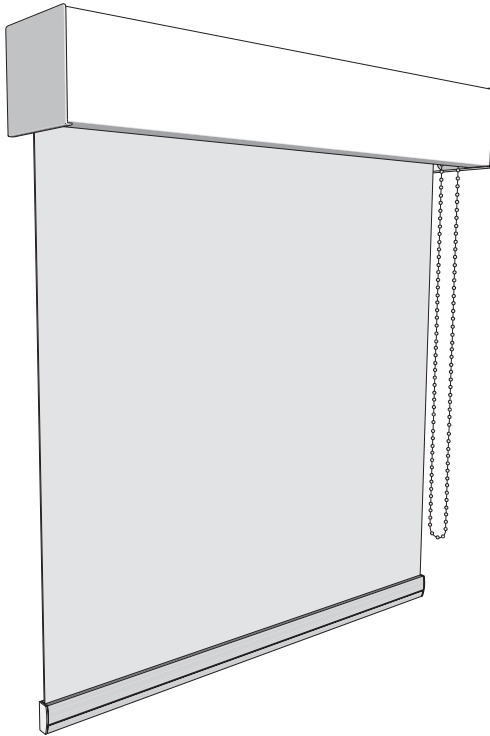

TIGER WINDOW FASHIONS

4 Inch Fascia Bead Chain Roller Shade Installation Instructions

Step-by-step instructions for proper installation of your new roller shade.



Getting Started

Carefully unpack your shade(s) and check to make sure you have all of the following installation parts for each of your shades. It is recommended to read this manual before proceeding with the installation.

Parts Included:

- Mounting Bracket Screws
- Mounting Brackets (x2)
- Bead Chain Tension Device

Note:

The mounting brackets must be securely attached to the mounting surface. If your screws do not hit wood studs, you may have to use a different fastener available at any hardware store.

Recommended Tools:

- Drill with 1/8" bit
- Phillips screwdriver
- Tape Measure

ATTENTION. According to the Window Covering Manufacturers Association Inc., all labels must not be removed from the product.

ATTENTION. To comply with child safety standards, all tension devices must be installed per the installation instructions provided in step 3.

Note: For thicker fabrics or longer lengths you may be provided with the larger 2" Skyline bracket or the Large Tiger Designer Metal Bracket to accommodate the larger roll diameter. In this case please refer to the minimum mounting depth requirement chart.

Care and Cleaning

Minimal care and cleaning is needed to maintain the beauty of your shades. **To vacuum:** Use a hand held, low suction vacuum. **To dust:** Use a soft, clean cloth or feather duster. If using a mild cleaning solution, test on small area of fabric to make sure there will be no discoloration prior to application.

Step 1 - Select Mounting Option

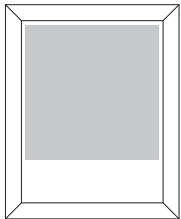

Inside Mount (IB)

Inside mount installations attach the brackets to the window frame, window molding, wall or ceiling, as shown. Internal shade roll brackets are universal so clutch mechanism may be mounted on either side.

See Step 2A.

Minimum mount depth: 3-3/4 in. (95mm)
Projection: 4 in. (102mm)

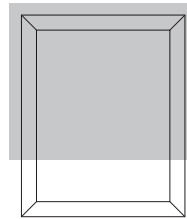

Outside Mount (OB)

Outside mount installations attach the brackets to the window casing, frame, molding, wall or ceiling, as shown. Internal shade roll brackets are universal so clutch mechanism may be mounted on either side.

See Step 2B.

Minimum flat vertical surface: 1 in. (25mm) wide
Projection: 4 in. (102mm)

Step 2A - Install Mounting Brackets - Inside Mount (IB)

Top Mount

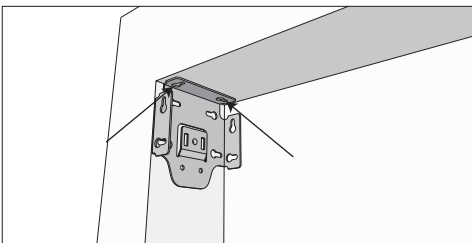

Side Mount

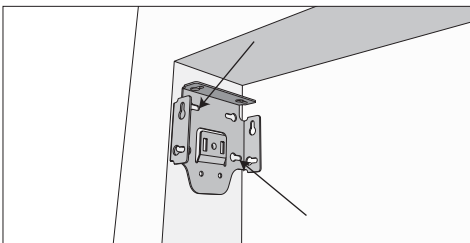

Shallow Depth Mount

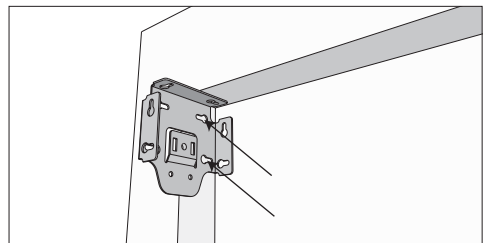

Holding the bracket in place, flush with front of opening, mark the mounting screw locations in the top of the bracket (option 1) or the side of the bracket (option 2) with a pencil. Pre-drill marked locations using a 1/8 in. drill bit. Attach the brackets using the supplied mounting screws and a Phillips screwdriver.

For outside mount installation see Step 2B.



TIGER WINDOW FASHIONS

4 Inch Fascia Bead Chain Roller Shade Installation Instructions

Step-by-step instructions for proper installation of your new roller shade.

Step 2B - Install Mounting Brackets - Outside Mount (OB)

Ceiling Mount

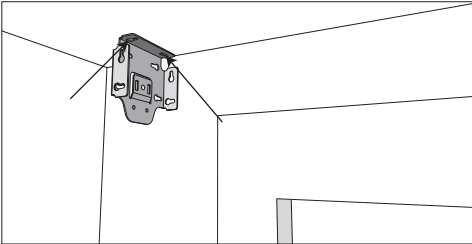

Wall Mount

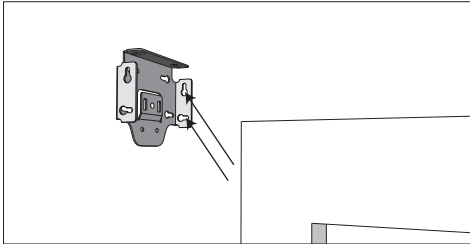

Casing/Frame/Molding Mount

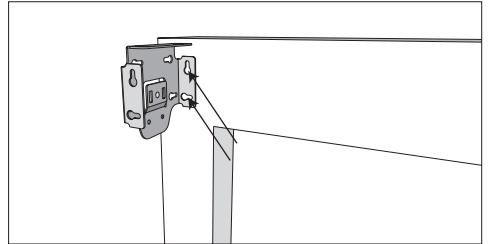

Fit the shade into the brackets and center the shade over the window (this may take two people). With a pencil, mark the wall on the side of one bracket. Remove the shade and then attach the one bracket with two screws. Next, insert the shade into the second bracket. Hold the shade up and insert other end into the already mounted bracket, making sure that the shade is level. Mark the wall on the side of the second bracket. Remove the shade and install second bracket with two screws.

Step 3 - Inserting the Shade

Step 3A: Insert the spring loaded pin end into the round hole of the mounting bracket. Pushing the pin end towards its bracket, insert the hooks on the clutch side straight into the two slots in the mounting bracket.

Step 3B: Once the two hooks are through the slots, gently pull down on the clutch until the two hooks have locked securely to the bracket. The bottom of the clutch should point straight down.

Step 3A

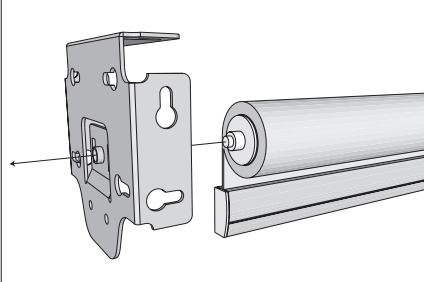

Step 3B

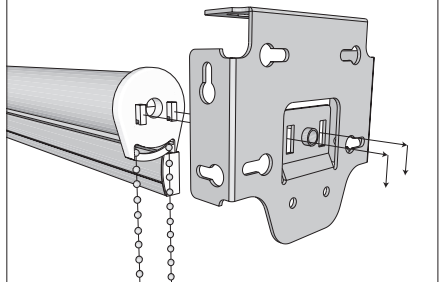

Step 4 - Mount the Fascia

Position the fascia so that point (A) of the fascia panel rests on the top lip of both brackets. Push the bottom front of the fascia firmly backwards and toward the window until the lip on the rear of the fascia engages the bracket and snaps into place, (B) as shown.

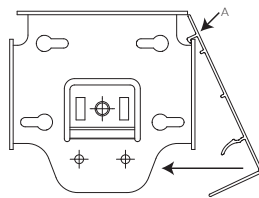

Push Fascia backwards and toward the window

Step 4B (Optional Outside Mount):

Slide bracket covers over mounting brackets until they lock securely into place.

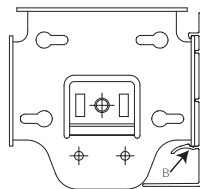

Note: Roller shades are not meant to be lowered past the ordered length and will come with additional material that is automatically added in length to conceal the roller tube and to help secure the fabric to the roll. Metal ball stops are placed in the chain to prevent the shade from being raised or lowered past its limits. When the length of the chain is shorter than the length of the shade, there will be no chain stop.

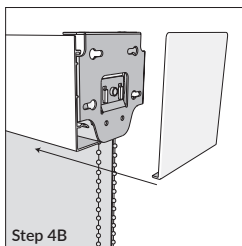

Step 4B

Step 5 - Installing Tension Device

The tension device should be positioned on the window frame or the wall so that the tension device and bead chain do not interfere with operation of window treatment.

The tension device should be installed so that the bead chain is taut without stretching or pulling on it. Stretching the bead chain will cause excessive wear. Do not twist or cross the bead chain.

Once installed, the loop should pass freely through the tension device.

Note: When attaching to wood, included screws can be screwed directly into wood. When attaching to wall and metal, use anchors that are designed for such substrates available at your local hardware store.

Inside Mount

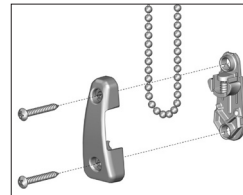

Outside Mount

